



Masterline® Design & Mfg., Inc.

DESIGN SERVICES & PRODUCTS

41580 Production Dr. • Harrison Twp., Michigan 48045 • (586) 463-5888 • Fax (586) 463-8817

## MASTERLINE SPECIAL TOLERANCE DOUBLE RETAINER SHAFT ASSEMBLY (FOR PTFE BEARINGS)

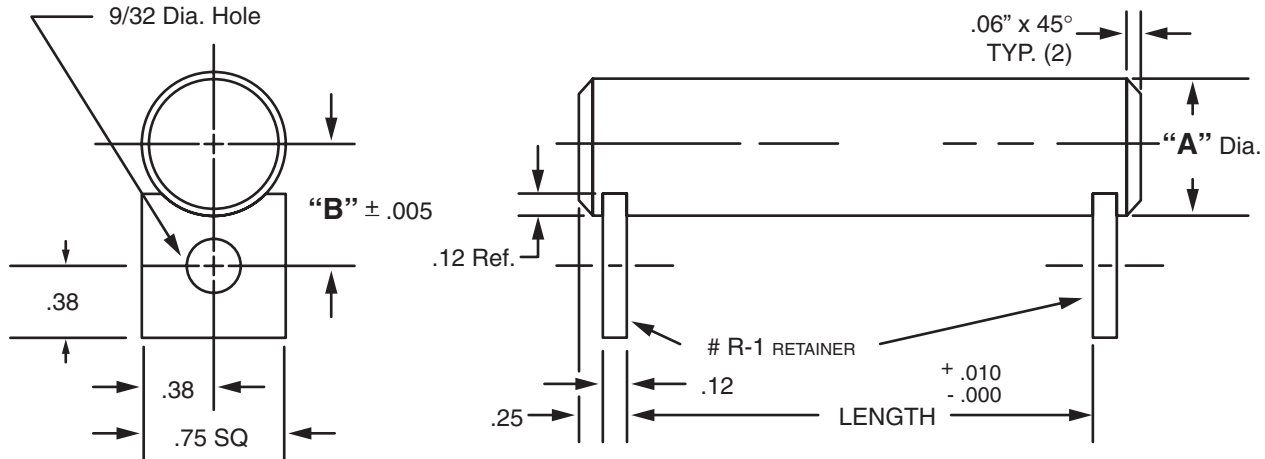

"A" Dia.	"B" Dim.	Cad File No.
1/8	.1243 .1236	.375 SDZ1-8
5/32	.1554 .1547	.390 SDZ5-32
3/16	.1865 .1858	.406 SDZ3-16
1/4	.2490 .2481	.375 SDZ1-4
5/16	.3115 .3106	.406 SDZ5-16
3/8	.3740 .3731	.437 SDZ3-8
7/16	.4365 .4355	.468 SDZ7-16
1/2	.4990 .4980	.500 SDZ1-2

"A" Dia.	"B" Dim.	Cad File No.
9/16	.5615 .5605	.531 SDZ9-16
5/8	.6240 .6230	.562 SDZ5-8
11/16	.6865 .6855	.593 SDZ11-16
3/4	.7491 .7479	.625 SDZ3-4
13/16	.8116 .8104	.656 SDZ13-16
7/8	.8741 .8729	.687 SDZ7-8
1	.9991 .9979	.750 SDZ1

Available in two (2) series:

"DSDU"— mild carbon steel, ground to size

"DSDY"— 304 Stainless Steel

Each assembly includes one shaft and two retainers. Stainless steel retainer provided with series "DSDY".

Other retainers are available on request. (see Section VII, page 17 – 20).

Shafts and retainers may be ordered separately.

### Masterline Special Tolerance Double Retainer Shaft Assembly (for PTFE Bearings)

#### How To Order:

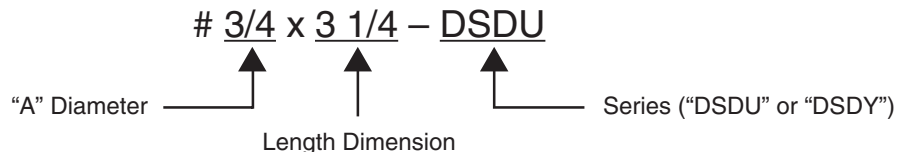

All Parts Available In Inch And Metric.