



Masterline® Design & Mfg., Inc.

DESIGN SERVICES & PRODUCTS

41580 Production Dr. • Harrison Twp., Michigan 48045 • (586) 463-5888 • Fax (586) 463-8817

MASTERLINE METRIC DOUBLE-FLAT SET SCREW SHAFT WITH LUBE HOLE

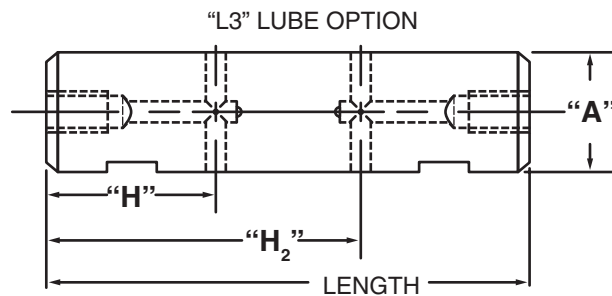
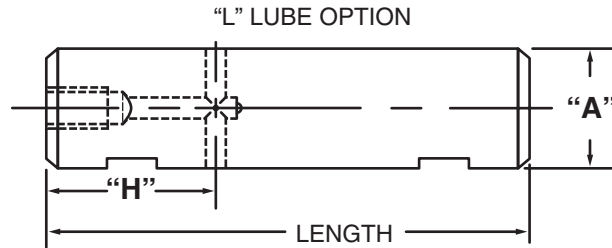

Lube options are not available under 13M dia. shaft.

Lube options in 13M - 16M dia. shafts have a 1/4 - 28 tapped hole in end.

All other diameter shafts have 1/8 - 27 N.P.T. in ends.

Optional thread for 1/4 - 28 is M6 - 1.0 & optional thread for 1/8 - 27 N.P.T. is 1/8 - 28 B.S.P.T.

"L3" option is recommended for use on shafts 250mm or longer when more than one cross-hole is necessary and access to both ends of shaft is possible.

Masterline Metric Double-Flat Set Screw Shaft with Lube Hole

(Note: Refer to Section II, page 36 for additional ordering information.)

How To Order: # 20M x 100M - SDH L - 20M - 60M - 35M - 65M - Optional Thread

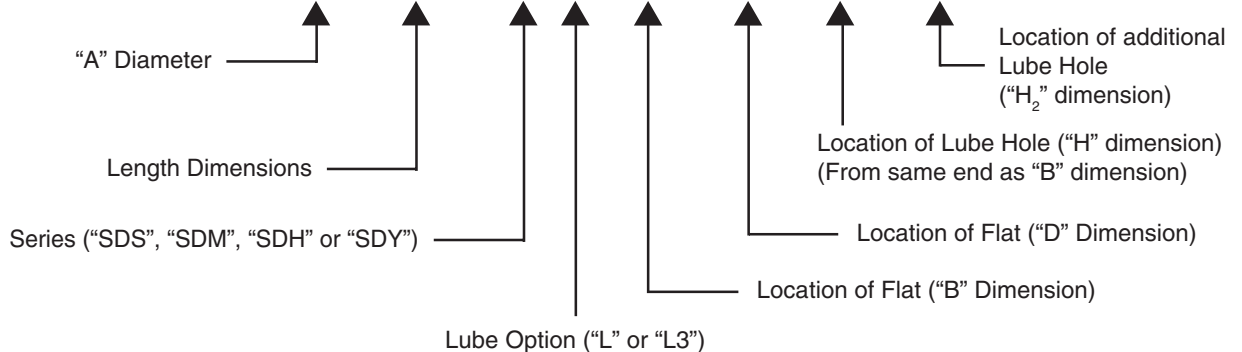

All Parts Available In Inch And Metric.