



Masterline® Design & Mfg., Inc.

DESIGN SERVICES & PRODUCTS

41580 Production Dr. • Harrison Twp., Michigan 48045 • (586) 463-5888 • Fax (586) 463-8817

MASTERLINE HEADLESS COTTER PIN SHAFT

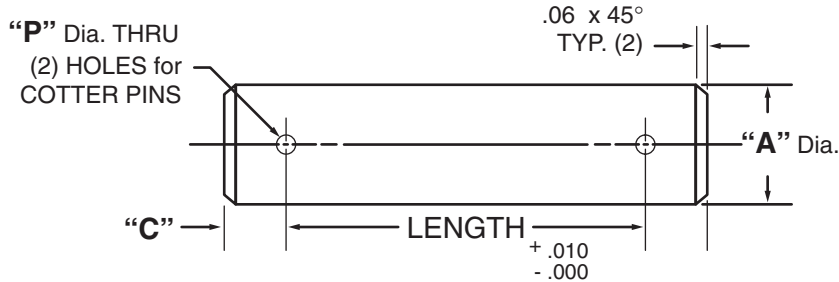

For Tolerance on "A" Dia., see Section I, page 7

"A" Dia.	"C" Dim.	"P" Dia.	Cad File No.	"A" Dia.	"C" Dim.	"P" Dia.	Cad File No.
.250	3/16	7/64	HCZ250	1.250	3/8	13/64	HCZ1250
.312	1/4	9/64	HCZ312	1.375	3/8	13/64	HCZ1375
.375	1/4	9/64	HCZ375	1.500	1/2	17/64	HCZ1500
.500	5/16	11/64	HCZ500	1.750	1/2	17/64	HCZ1750
.625	5/16	11/64	HCZ625	2.000	1/2	17/64	HCZ2000
.750	5/16	11/64	HCZ750	2.250	1/2	17/64	HCZ2250
.875	3/8	13/64	HCZ875	2.500	1/2	17/64	HCZ2500
1.000	3/8	13/64	HCZ1000	2.750	5/8	5/16	HCZ2750
1.125	3/8	13/64	HCZ1125	3.000	5/8	5/16	HCZ3000

Available in four (4) series:

"HCS" – 12L14 CRS

"HCM" – T.G. & P. Alloy, HDN R_c 28-32

"HCH" – 12L14 CRS, CARB., HDN. & GR., R_c 56-60 (.03 min. case)

"HCY" – 304 Stainless Steel

Other diameters are available on request. (see "How To Order")

Masterline Headless Cotter Pin Shaft

How To Order:

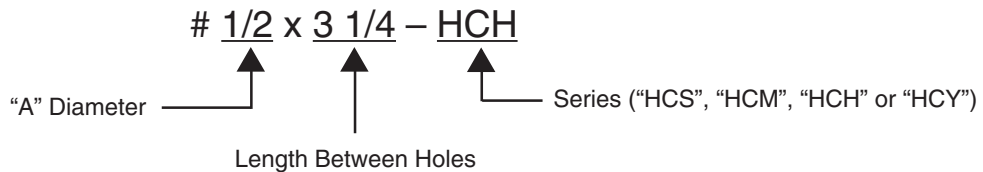

All Parts Available In Inch And Metric.